

Mini-Lathe Stand

Adjustable for the Seated User

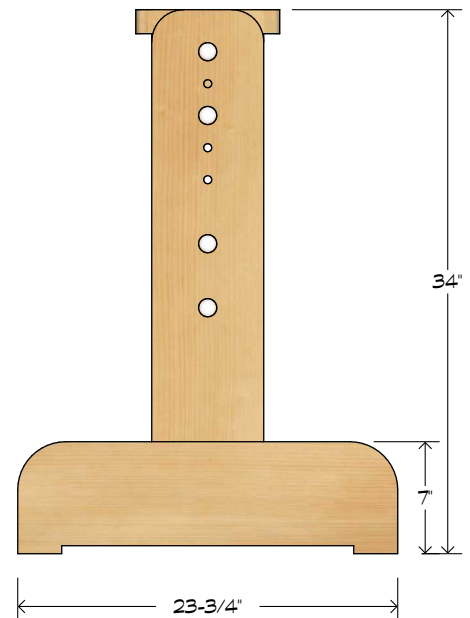

Exploded View and Materials List

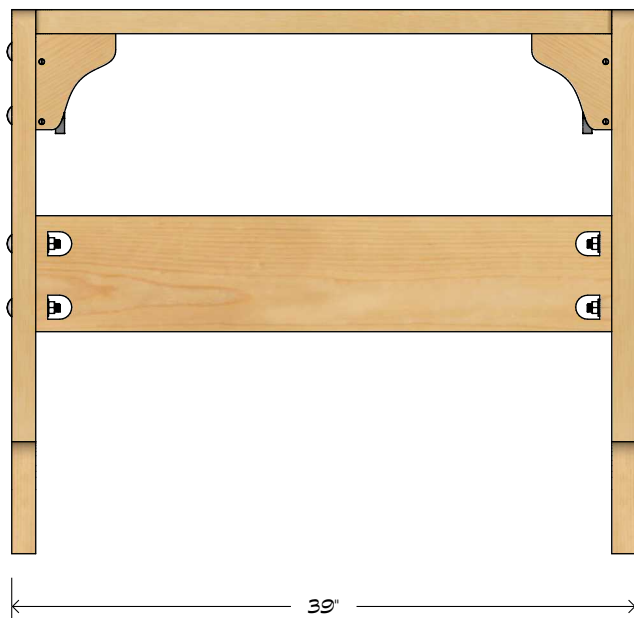
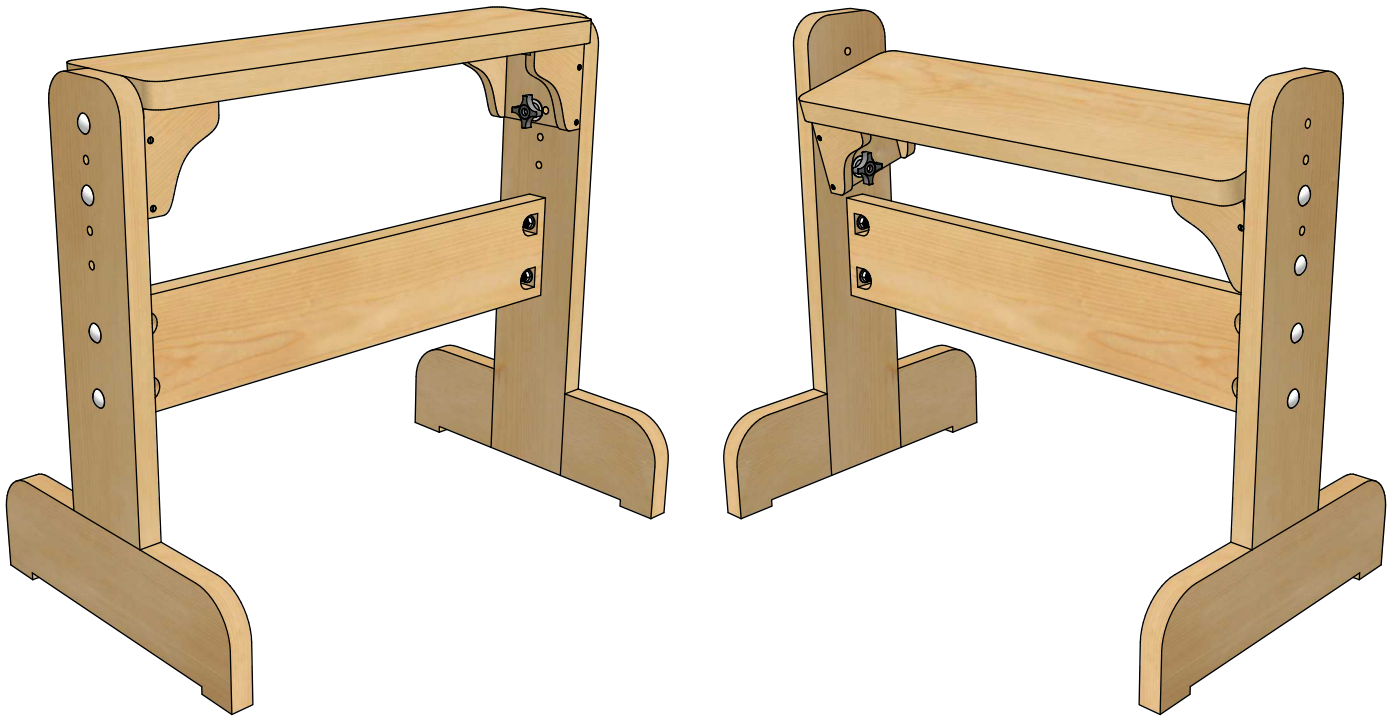
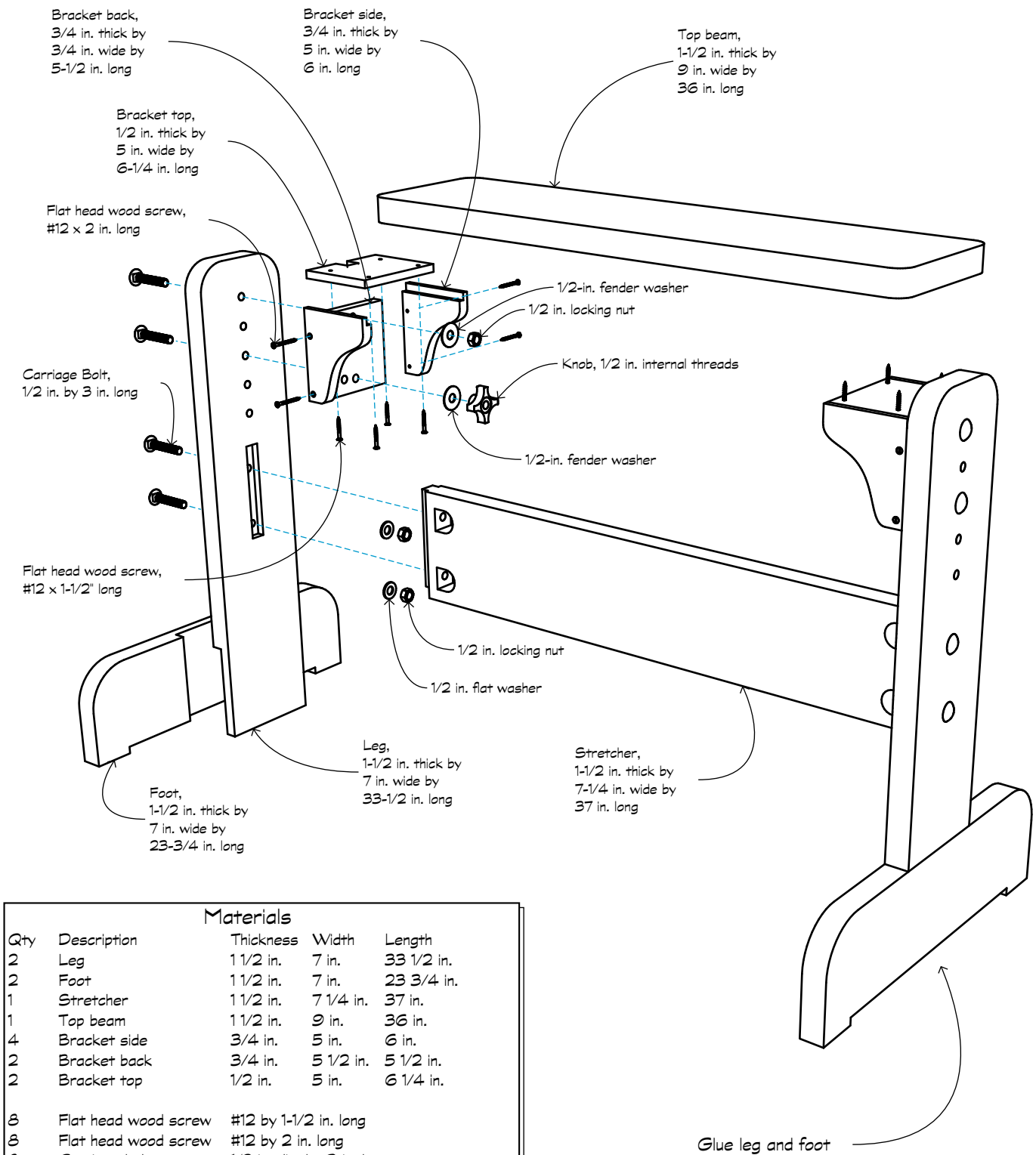

Materials

Qty	Description	Thickness	Width	Length
2	Leg	1 1/2 in.	7 in.	33 1/2 in.
2	Foot	1 1/2 in.	7 in.	23 3/4 in.
1	Stretcher	1 1/2 in.	7 1/4 in.	37 in.
1	Top beam	1 1/2 in.	9 in.	36 in.
4	Bracket side	3/4 in.	5 in.	6 in.
2	Bracket back	3/4 in.	5 1/2 in.	5 1/2 in.
2	Bracket top	1/2 in.	5 in.	6 1/4 in.
8	Flat head wood screw	#12 by 1-1/2 in. long		
8	Flat head wood screw	#12 by 2 in. long		
8	Carriage bolt	1/2 in. dia. by 3 in. long		
6	Locking nut	1/2 in.		
4	Flat washer	1/2 in.		
4	Fender washer	1/2 in.		
2	Knob	1/2 in. internal thread		

Frame Parts

D-shaped holes for nuts with flat washer,
1-1/2" dia., thru, cut flat with chisel.

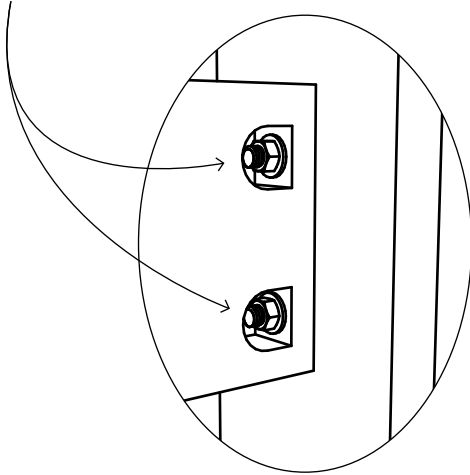

Stretcher detail

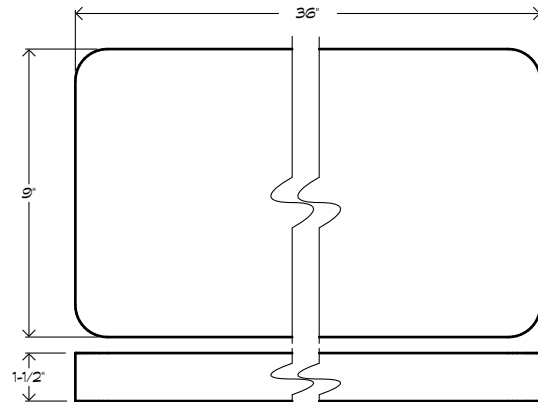

Top beam

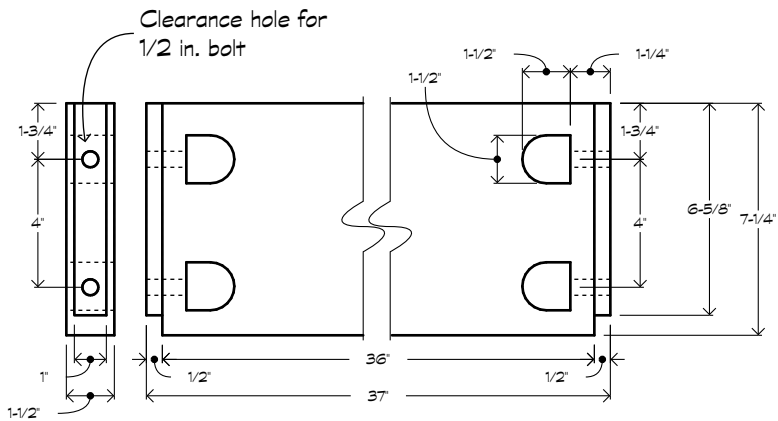

Stretcher

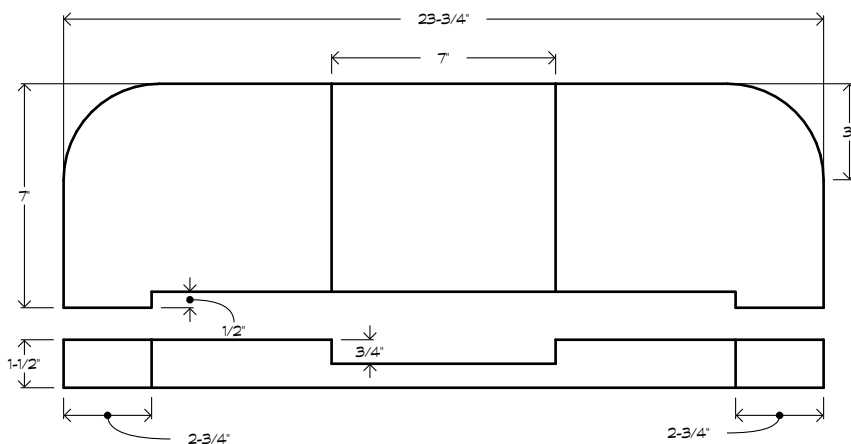

Foot

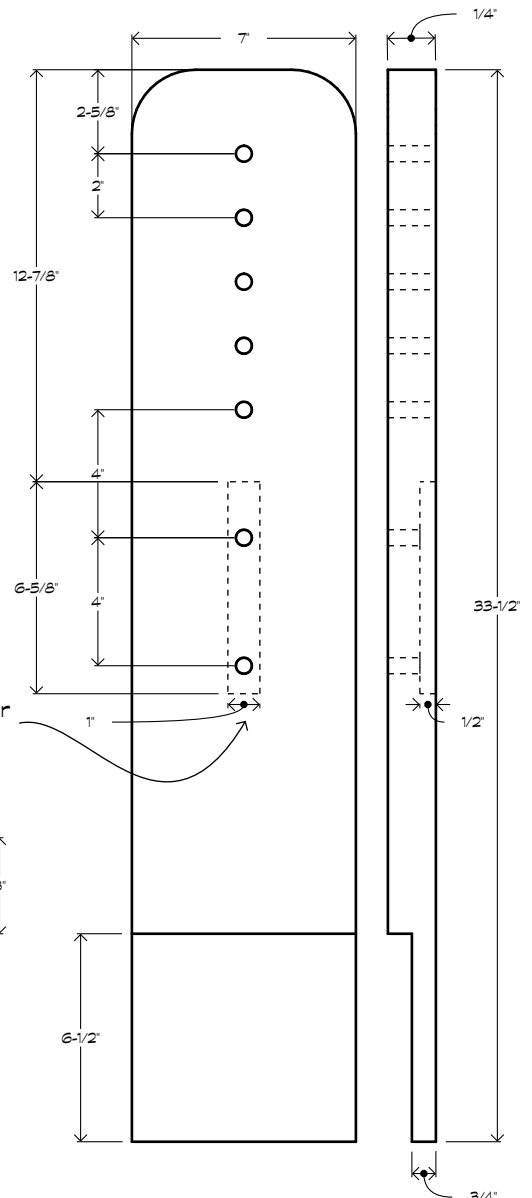

Leg

Brackets for Top Beam

Glue and screw top beam to bracket top. Layout for lathe mounting holes before adding screws to avoid conflicts

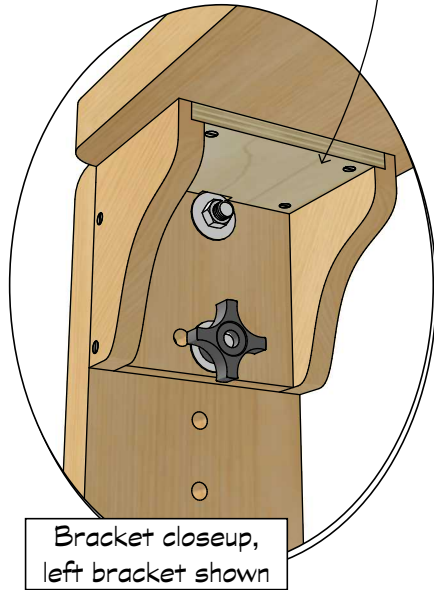

Notch in bracket top, 1 in. wide by 1 in. deep provides clearance for fender washer

Bracket top, 1/2 in. thick by 5 in. wide by 6-1/4 in. long

Bracket back, 3/4 in. thick by 3/4 in. wide by 5-1/2 in. long

This hole is optional. It allows lathe to be tilted toward the user

Clearance holes for 1/2-in. bolts

Bracket side, 3/4 in. thick by 5 in. wide by 6 in. long

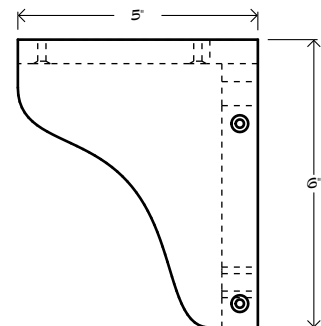
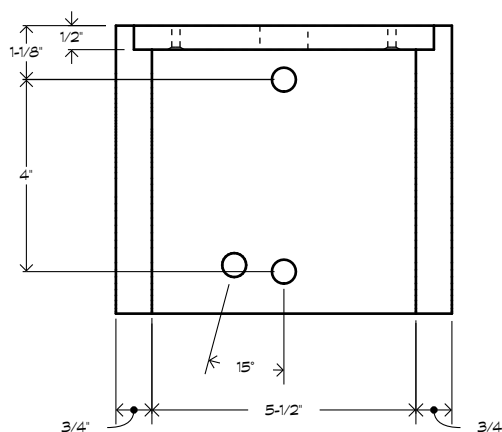
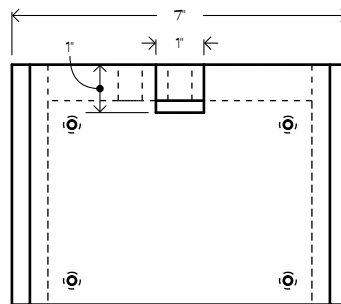

Detail for Optional No Tools Knock-Down Assembly

